



Building Schools for the Future at Haringey

The Heartlands High /
Alexandra Park Club Playing Fields Project

Sam Davidson
09.05.11



Building schools for the future



Haringey Council

Executive Summary

- The purpose of this paper is to provide the Alexandra Park and Palace Charitable Trust, with an update on the Alexandra Park Club/Heartlands partnership.
- The paper will explain the overarching objectives of the project
- The funding position will be clarified, and the two phases will be explained, with detailed drawings.
- The clubs proposals will be explained
- The proposals for use by the school will be highlighted
- There will be an opportunity for any further questions/points to be raised.

Background to project

- The Office of the Schools Adjudicator (OSA) decided on a competition for Heartlands High School, which led to it opening as a community school.
- Three conditions were placed on this decision:
 1. The scheme received the grant of planning permission.
 2. **The School “acquired” playing fields**
 3. **The School secured any necessary access to the playing fields.**
- Primary objective of project: **To provide Heartlands High School with access to playing fields**

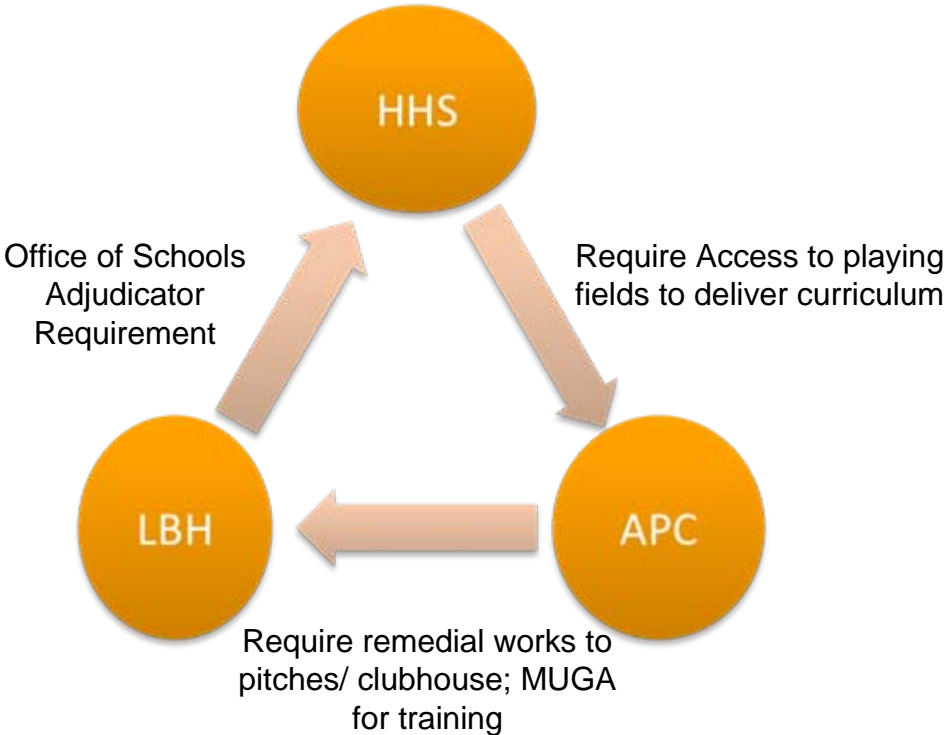

The Alexandra Park Club



Contact Number
 Alexandra Palace Reception: 020 8365 2121

Byelaws apply
 See notice boards for details.



Funding Position

Funding Source	Amount
Strategic Sports Pitch Improvements Programme in (ACCS)	£300K - Secured
Heartlands High School Provisional Sums	£225K - Secured
Alexandra Park Club	£TBC
Football Foundation	£TBC pending outcome of review
Project Budget	£525K Secured NB There is potential for additional funds



Two Phased Approach

Phase I - Pitches/Clubhouse (Due to complete October 2011)

- Access to pitches/clubhouse meet the schools objectives for the project
- Drains will run into ditch, and balancing ponds will allow areas of standing water.
- Pitches will take around a year to “bed-in”.
- Minor internal reconfigurations to clubhouse, which will enable external access to toilets/changing facilities
- School would have access to drained pitches, and improved on-site facilities by September 2012

Phase II – 3G (3rd Generation) Training Facility (Due to Complete May 2012)

- Enables on-site training for the club, and alternative provision for the school, should the pitches be waterlogged
- A significant amount of consultation will be required in order to ensure that all interested parties have had an opportunity to scrutinise the design
- The facility would be floodlit, however there would be minimal impact on surrounding conservation area and relevant surveys would be carried out prior to commissioning works

Budget

Phase 1	
Pitch Drainage	£ 200,000
Clubhouse	£150,000
Total	£350,000

Phase 2	
3G MUGA (LBH)	£ 130,000
3G MUGA (Football Foundation)	£130,000
Total	£260,000



How the club intend to enhance their use the facility

- The Alexandra Park Club is a local community led football and cricket sports club with a long and proud history of providing sporting opportunities. The APFC and APYFC are FA Chartered Standard accredited and the clubs deliver child protection, coaching, first aid and referee training courses.
- Once the improvement works have taken place, the club will be able to make use of the pitches throughout the wetter months, carry out training on-site and maintain the facility with much greater ease.

What the club provides for school/community

- Fantastic facilities for school use, both during school hours and for non-curricular time
- The opportunity to form a unique partnership between a well established club, and a school, enabling pupils to not only make use of the facilities, but also gain access to the coaching and training courses provided.



How the school intend to use the facility

- Heartlands High school will not reach full capacity until 2014, at which point it will have 5 cohorts, consisting of children aged 11-16
- Once the school is at full capacity it will use the pitches as follows:

Curriculum Usage

Field usage away from the pitches – 20 hours per week.

Extra curricular Usage

Winter terms - Football pitches – 5 pitches to be used once in a week. (5 hours)

Summer term – Cricket pitch – 1 pitch for 3 days (9 hours a week)

- The school will also use the facility for athletics during the summer term

What the school provides for club/community

- 4 cricket nets for training all-year round, which the club will have access to
- 5 a-side training facility which is available for use by both the club (youth teams), and members of the local community
- Sports hall with state-of-the-art facilities available for lets from September 2011.

Any questions?





FLOOR PLAN AS EXISTING.

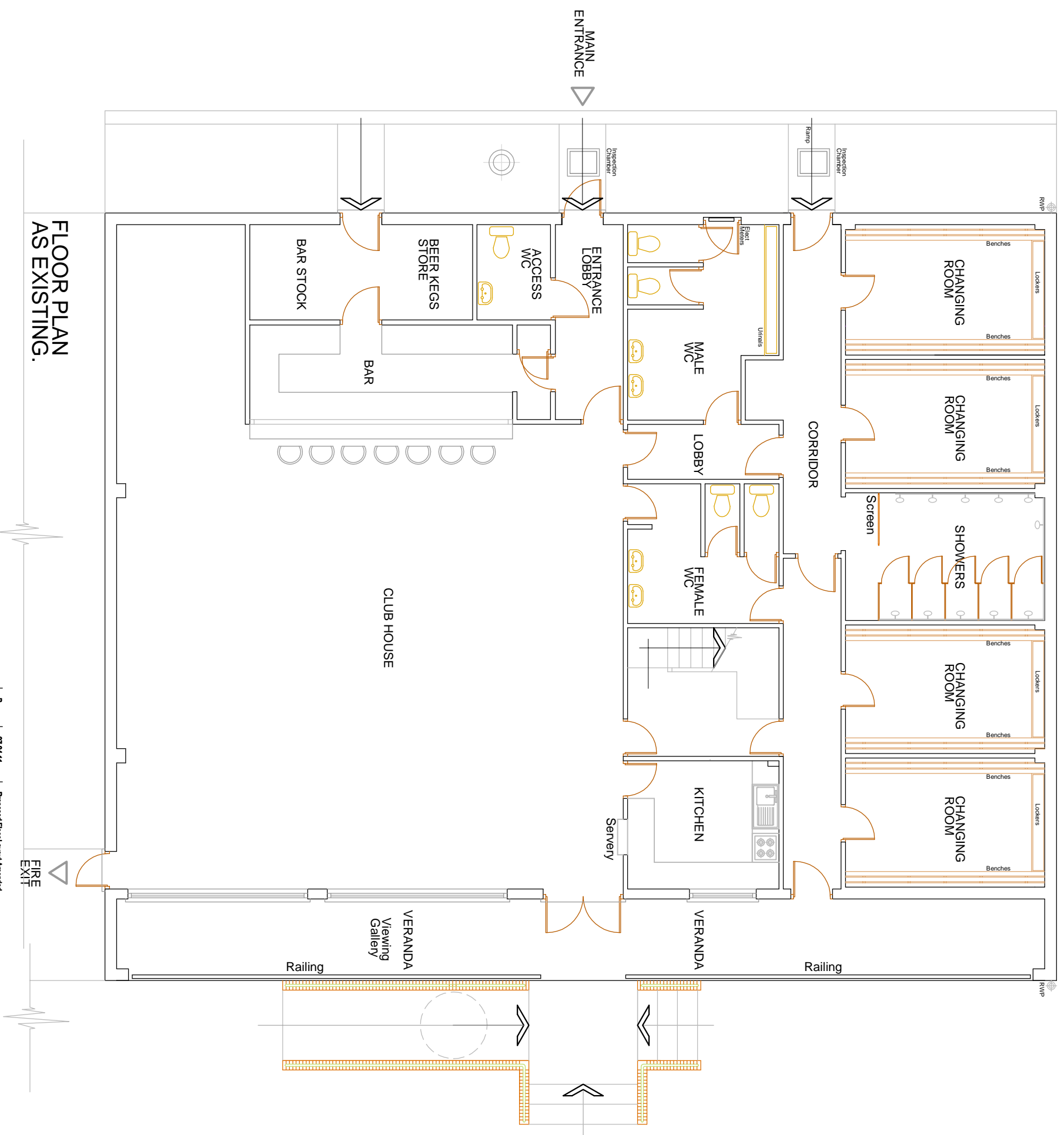

FLOOR PLAN AS EXISTING.

Do not scale from this Drawing.
All dimensions to be checked on Site.

REV	A	DATE	07/04/11	DESCRIPTION	Proposed Floor Layout Revised Proposed Floor Layout Approved	SCALE	1:100 @ A2
REV	B	DATE	18/03/11	DESCRIPTION	Proposed Floor Layout Approved	SCALE	1:100 @ A2
PROJECT NR	01		DRAWING NR	B		CHECKED	A.M.
PROJECT				CLIENT			
NPS London Ltd.- 3-4 Avocet House Trinity Way Chingford, London, E4 8TD Tel: 020 8523 6262 Fax: 020 8523 6300				HARINGEY CORPORATE SERVICES			
SUBJECT				DATE			
ALEXANDRA PALACE CLUBHOUSE				APRIL 2011			
HEART ISLAND SCHOOL				1:100 @ A2			
FLOOR LAYOUTS AS EXISTING & PROPOSED.				DRAWN			
PROJECT NR				G.D.			
JRHAR088				A.M.			



www.nps.co.uk

NPS PROPERTY CONSULTANTS LTD.
NPS NORTH EAST LTD.
NPS NORTH WEST LTD.
NPS STOCKPORT LTD.

© NPS This drawing may not be reproduced in any form without prior written agreement.